

ARROW ENGINEERING & CONSTRUCTION SERVICES, LLC

Date: 04/29/2026

Hampton Raulerson
County Manager
212 E. Central Avenue
Fitzgerald, Ga 31750
Hampton.raulerson@benhillcounty-ga.gov
229-426-5100 Office
912-390-0080 Cell

Re: Acceptance Letter for Change Order #2 Price from East Coast Asphalt
Ben Hill County, GA

Subject: Engineer's Recommendation of Approval for Change Order #2

Dear Mr. Raulerson:

I have reviewed East Coasts Price for Change Order #2 of **\$ 239,064.50** for the Proposed Improvements where our New Road will tie into Perry House Road. Please see the attached sheets C2.4A-P&P and C2.4B-P&P. I recommend approval by the County for the proposed work.

The work is to include all necessary materials, demolition, labor, paving, grading, traffic control, erosion control, permanent grassing, pavement markings and signage as well as all other work that may be required and has been called for in the project manual elsewhere on the project.

Should you require additional information please contact me at lsanders@arrowengineeringgroup.com or on my cell at (229-561-2733).

Sincerely,



H. Larry Sanders, P.E.

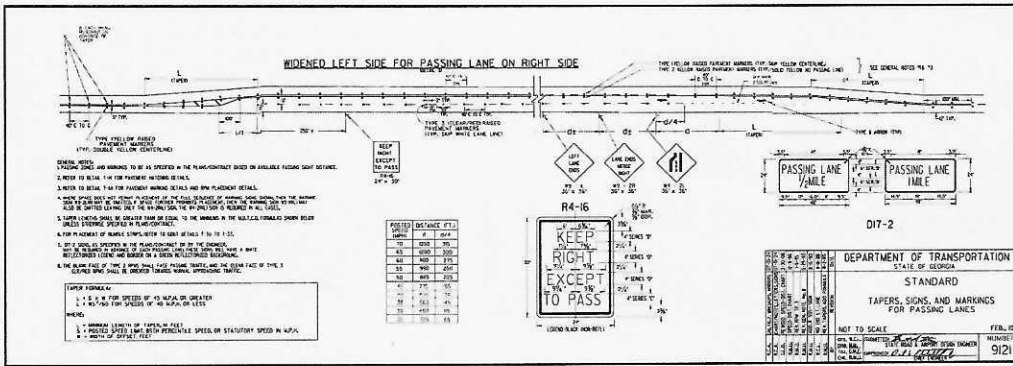
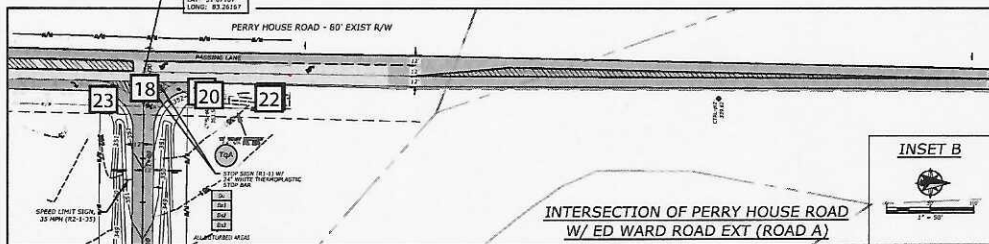
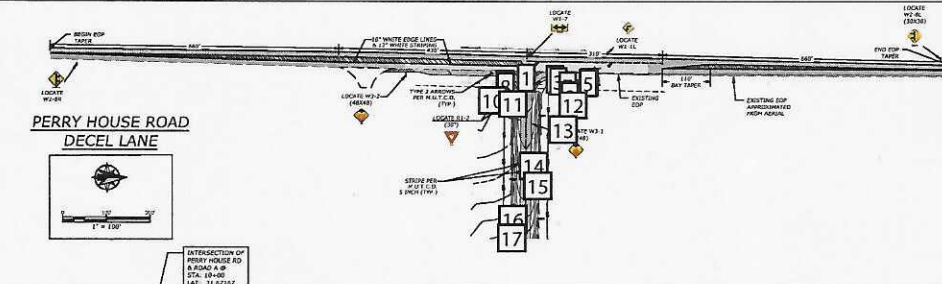
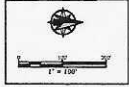

**PERRY HOUSE ROAD
DECEL LANE**

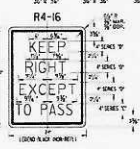

- GENERAL NOTES:**
1. ALL DIMENSIONS AND MARKINGS TO BE AS SHOWN IN THE PLACEMENT SHEET OR AVAILABLE TYPICAL SIGN DETAILS.
 2. REFER TO SHEET FOR THE SIGN NUMBER AND DETAIL.
 3. REFER TO SHEET FOR THE PASSING LANE TAPER AND SIGN PLACEMENT DETAIL.
 4. REFER TO SHEET FOR THE PASSING LANE TAPER AND SIGN PLACEMENT DETAIL.
 5. REFER TO SHEET FOR THE PASSING LANE TAPER AND SIGN PLACEMENT DETAIL.
 6. THE SIGN FACE OF THIS SIGN SHALL BE LOCATED AS SHOWN IN THE SIGN PLACEMENT SHEET OR AVAILABLE TYPICAL SIGN DETAILS.
 7. REFER TO SHEET FOR THE SIGN NUMBER AND DETAIL.
 8. REFER TO SHEET FOR THE SIGN NUMBER AND DETAIL.
 9. REFER TO SHEET FOR THE SIGN NUMBER AND DETAIL.
 10. REFER TO SHEET FOR THE SIGN NUMBER AND DETAIL.
- TABLE:**
- | POSTED (DISTANCE FT.) | POSTED (DISTANCE FT.) |
|-----------------------|-----------------------|
| 100 | 100 |
| 200 | 200 |
| 300 | 300 |
| 400 | 400 |
| 500 | 500 |
| 600 | 600 |
| 700 | 700 |
| 800 | 800 |
| 900 | 900 |
| 1000 | 1000 |



**DEPARTMENT OF TRANSPORTATION
STATE OF GEORGIA**

**STANDARD
TAPERS, SIGNS, AND MARKINGS
FOR PASSING LANES**

NOT TO SCALE

FEB. 1993

TELEPHONE: 9121

**GRADING PLAN AT PERRY HOUSE RD FOR
BEN HILL COUNTY
ROAD PROJECT
LOCATED IN LL 61 OF THE 3RD L.D.
FITZGERALD, GA**

**ARROW ENGINEERING
A CONSTRUCTION SERVICES
CORPORATION**

PROJECT: 20034

SHEET
C2.4B

Summary of Comments on C2.4B-P&P

Page: [1] C2.4B-P&P

<input type="checkbox"/> Number: 1 353	Author: AutoCAD SHX Text	Date: Indeterminate
<input type="checkbox"/> Number: 2 352	Author: AutoCAD SHX Text	Date: Indeterminate
<input type="checkbox"/> Number: 3 351	Author: AutoCAD SHX Text	Date: Indeterminate
<input type="checkbox"/> Number: 4 350	Author: AutoCAD SHX Text	Date: Indeterminate
<input type="checkbox"/> Number: 5 349	Author: AutoCAD SHX Text	Date: Indeterminate
<input type="checkbox"/> Number: 6 352	Author: AutoCAD SHX Text	Date: Indeterminate
<input type="checkbox"/> Number: 7 351	Author: AutoCAD SHX Text	Date: Indeterminate
<input type="checkbox"/> Number: 8 353	Author: AutoCAD SHX Text	Date: Indeterminate
<input type="checkbox"/> Number: 9 352	Author: AutoCAD SHX Text	Date: Indeterminate
<input type="checkbox"/> Number: 10 353	Author: AutoCAD SHX Text	Date: Indeterminate
<input type="checkbox"/> Number: 11 352	Author: AutoCAD SHX Text	Date: Indeterminate
<input type="checkbox"/> Number: 12 10' UTILITY EASEMENT D.B. 565 PG. 234	Author: AutoCAD SHX Text	Date: Indeterminate
<input type="checkbox"/> Number: 13 351	Author: AutoCAD SHX Text	Date: Indeterminate
<input type="checkbox"/> Number: 14 350	Author: AutoCAD SHX Text	Date: Indeterminate
<input type="checkbox"/> Number: 15 349	Author: AutoCAD SHX Text	Date: Indeterminate
<input type="checkbox"/> Number: 16 348	Author: AutoCAD SHX Text	Date: Indeterminate
<input type="checkbox"/> Number: 17 347	Author: AutoCAD SHX Text	Date: Indeterminate
<input type="checkbox"/> Number: 18 353	Author: AutoCAD SHX Text	Date: Indeterminate
<input type="checkbox"/> Number: 19 352	Author: AutoCAD SHX Text	Date: Indeterminate
<input type="checkbox"/> Number: 20 351	Author: AutoCAD SHX Text	Date: Indeterminate
<input type="checkbox"/> Number: 21 350	Author: AutoCAD SHX Text	Date: Indeterminate
<input type="checkbox"/> Number: 22 349	Author: AutoCAD SHX Text	Date: Indeterminate
<input type="checkbox"/> Number: 23 352	Author: AutoCAD SHX Text	Date: Indeterminate

Comments from page [1] C2.4B-P&P continued on next page

<input type="checkbox"/> Number: 24 351	Author: AutoCAD SHX Text	Date: Indeterminate
<input type="checkbox"/> Number: 25 353	Author: AutoCAD SHX Text	Date: Indeterminate
<input type="checkbox"/> Number: 26 352	Author: AutoCAD SHX Text	Date: Indeterminate
<input type="checkbox"/> Number: 27 353	Author: AutoCAD SHX Text	Date: Indeterminate
<input type="checkbox"/> Number: 28 352	Author: AutoCAD SHX Text	Date: Indeterminate
<input type="checkbox"/> Number: 29 10' UTILITY EASEMENT D.B. 565 PG. 234	Author: AutoCAD SHX Text	Date: Indeterminate
<input type="checkbox"/> Number: 30 351	Author: AutoCAD SHX Text	Date: Indeterminate

Summary of Comments on C2.4A-P&P

Page: [1] C2.4A-P&P

<input type="checkbox"/> Number: 1 353	Author: AutoCAD SHX Text	Date: Indeterminate
<input type="checkbox"/> Number: 2 352	Author: AutoCAD SHX Text	Date: Indeterminate
<input type="checkbox"/> Number: 3 351	Author: AutoCAD SHX Text	Date: Indeterminate
<input type="checkbox"/> Number: 4 350	Author: AutoCAD SHX Text	Date: Indeterminate
<input type="checkbox"/> Number: 5 349	Author: AutoCAD SHX Text	Date: Indeterminate
<input type="checkbox"/> Number: 6 352	Author: AutoCAD SHX Text	Date: Indeterminate
<input type="checkbox"/> Number: 7 353	Author: AutoCAD SHX Text	Date: Indeterminate
<input type="checkbox"/> Number: 8 351	Author: AutoCAD SHX Text	Date: Indeterminate
<input type="checkbox"/> Number: 9 352	Author: AutoCAD SHX Text	Date: Indeterminate
<input type="checkbox"/> Number: 10 353	Author: AutoCAD SHX Text	Date: Indeterminate
<input type="checkbox"/> Number: 11 352	Author: AutoCAD SHX Text	Date: Indeterminate
<input type="checkbox"/> Number: 12 10' UTILITY EASEMENT D.B. 565 PG. 234	Author: AutoCAD SHX Text	Date: Indeterminate
<input type="checkbox"/> Number: 13 351	Author: AutoCAD SHX Text	Date: Indeterminate
<input type="checkbox"/> Number: 14 350	Author: AutoCAD SHX Text	Date: Indeterminate
<input type="checkbox"/> Number: 15 349	Author: AutoCAD SHX Text	Date: Indeterminate
<input type="checkbox"/> Number: 16 348	Author: AutoCAD SHX Text	Date: Indeterminate
<input type="checkbox"/> Number: 17 353	Author: AutoCAD SHX Text	Date: Indeterminate
<input type="checkbox"/> Number: 18 352	Author: AutoCAD SHX Text	Date: Indeterminate
<input type="checkbox"/> Number: 19 351	Author: AutoCAD SHX Text	Date: Indeterminate
<input type="checkbox"/> Number: 20 350	Author: AutoCAD SHX Text	Date: Indeterminate
<input type="checkbox"/> Number: 21 349	Author: AutoCAD SHX Text	Date: Indeterminate
<input type="checkbox"/> Number: 22 352	Author: AutoCAD SHX Text	Date: Indeterminate
<input type="checkbox"/> Number: 23 351	Author: AutoCAD SHX Text	Date: Indeterminate

Comments from page [1] C2.4A-P&P continued on next page

- Number: 24 Author: AutoCAD SHX Text Date: Indeterminate
353

- Number: 25 Author: AutoCAD SHX Text Date: Indeterminate
352

- Number: 26 Author: AutoCAD SHX Text Date: Indeterminate
353

- Number: 27 Author: AutoCAD SHX Text Date: Indeterminate
352

- Number: 28 Author: AutoCAD SHX Text Date: Indeterminate
10' UTILITY EASEMENT D.B. 565 PG. 234

- Number: 29 Author: AutoCAD SHX Text Date: Indeterminate
351