

JAY, SHERRELL, SMITH, BRADDY & COOK, P.C.
ATTORNEYS AT LAW

CLAYTON JAY (1883-1969)
ALLAN C. GARDEN (1895-1972)
HARVEY L. JAY (1906-1992)
CLAYTON JAY, JR.
ROBERT E. SHERRELL
JOHN E. SMITH, III
M. GILL BRADDY
KYLE C. COOK

P.O. BOX 308
101 E. PINE ST.
FITZGERALD, GA 31750

TELEPHONE (229) 423-2027
FACSIMILE (229) 423-9327

December 12, 2022

CERTIFIED MAIL
RETURN RECEIPT REQUESTED

Mike Dinnerman,
County Manager
Ben Hill County, Georgia
402 East Pine Street
Fitzgerald, GA 31750

Re: Annexation to the City of Fitzgerald - Ordinance No. 23-1613

Dear Mike:

This letter serves as notification to the Board of Commissioners of Ben Hill County, Georgia, that the enclosed annexation ordinance has been enacted by the City of Fitzgerald, Georgia. Attached to said ordinances is a map which shows the property being annexed.

With Best Regards,

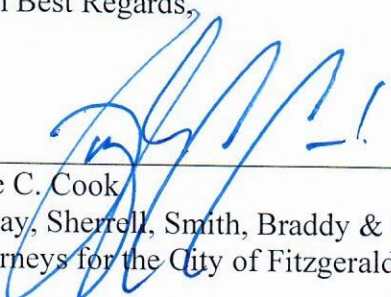

Kyle C. Cook
for Jay, Sherrell, Smith, Braddy & Cook, P.C.
Attorneys for the City of Fitzgerald

Enc

ORDINANCE NO. 23-1613

AN ORDINANCE TO AMEND THE CITY OF FITZGERALD ZONING DISTRICT MAP WITH RESPECT TO A TRACT CONTAINING 6.46 ACRES, MORE OR LESS, IN FIVE ACRE TRACTS NUMBERS 1243 AND 1244, AS SHOWN BY THE PLAT OF THE COLONY DOMAIN OF THE AMERICAN TRIBUNE SOLDIERS COLONY COMPANY OF FILE IN THE OFFICE OF THE CLERK OF THE SUPERIOR COURT OF IRWIN COUNTY, GEORGIA, LOCATED IN LAND LOT NUMBER 91, IN THE THIRD LAND DISTRICT OF BEN HILL COUNTY, GEORGIA, IN THE CITY OF FITZGERALD, GEORGIA, MORE SPECIFICALLY LOCATED AT THE NORTHEAST CORNER OF THE INTERSECTION OF THE RIGHT OF WAYS OF BENJAMIN H. HILL DRIVE AND PERRY HOUSE ROAD, FITZGERALD, GEORGIA 31750; AND THE RIGHT OF WAY ADJACENT THERETO; TO ANNEX SAID PROPERTY TO THE EXISTING CORPORATE LIMITS OF THE CITY OF FITZGERALD, GEORGIA; TO REZONE SAID PROPERTY FROM G-B (COUNTY) TO G-B (CITY); TO PROVIDE FOR AN EFFECTIVE DATE; TO PROVIDE FOR SEVERABILITY; TO REPEAL INCONSISTENT ORDINANCES AND PARTS OF ORDINANCES; AND FOR OTHER PURPOSES.

WHEREAS, the owner of the land hereinafter described has, by written and signed application, applied to the Mayor and Council of the City of Fitzgerald for said lands to be annexed to the existing corporate limits of the City of Fitzgerald, as provided by law, and particularly Georgia Laws 1963, page 119, as amended, and

WHEREAS, all requirements of law, including but not limited to the requirements of the Zoning Ordinance for the City of Fitzgerald, Georgia, with respect to a map amendment thereof have been complied with;

I certify that this is a true and exact copy of the record and/or records on file with the City Clerk's office.

Cristina Evans 12/12/23
City Clerk Date

NOW, THEREFORE, BE IT ORDAINED by the Mayor and Council of the City of Fitzgerald, as follows:

Section 1. From and after the passage of this ordinance the following described lands are hereby annexed to and incorporated into the corporate limits of the City of Fitzgerald, to wit:

6.46 acres, more or less, being a portion of Five Acre Tracts Numbers 1243 and 1244 as shown by the plat of the Colony Domain made by or for the American Tribune Soldiers Colony Company of file in the Office of the Clerk of the Superior Court of Irwin County, Georgia, in Land Lot Number 91 in the Third Land District of Ben Hill County, Georgia, and being more particularly described as beginning at the intersection of the North line of Five Acre Tract 1241 with the East margin of the right of way of Perry House Road, thence along said East right of way margin South 00 degrees 09 minutes 54 seconds West 636.12 feet to a point; thence continuing along said right of way margin along a curve having a radius of 20,692.86 feet, an arc length of 189.27 feet, and a chord bearing and distance of South 00 degrees 25 minutes 38 seconds West 189.27 feet to a point marked by an iron rebar pin, which point is the point and place of beginning; thence North 90 degrees 00 minutes 00 seconds East 488.03 feet to a point marked by an iron rebar pin; thence South 00 degrees 00 minutes 00 seconds East 544.01 feet to a point marked by an iron rebar pin; thence South 29 degrees 16 minutes 40 seconds East 39.84 feet to a point on the North margin of the right of way of Benjamin H. Hill Drive; thence along said right of way margin South 89 degrees 51 minutes 04 seconds West 105.92 feet to a point marked by an iron rebar pin; thence continuing along said right of way margin North 00 degrees 01 minute 02 seconds West 10.00 feet to a point marked by an iron rebar pin; thence continuing along said right of way margin South 89 degrees 58 minutes 58 seconds West 367.96 feet to a point marked by an iron rebar pin; thence North 46 degrees 26 minutes 46 seconds West 64.31 feet to a point on the East margin of the right of way of Perry House Road; thence along said East right of way margin along a curve having a radius of 20,692.86 feet, an arc length of 525.01 feet, and a chord bearing and distance of North 01

degree 24 minutes 58 seconds East 525.00 feet to a point, the same being the point and place of beginning; the same being shown by that certain plat of survey prepared by James D. Weeks, Georgia Registered Land Surveyor No. 2111, dated May 1, 2019, for ABCD, LP and recorded in the office of the Clerk of the Superior Court of Ben Hill County, Georgia, in Plat Book 23001 Page 00067 and said plat by reference thereto is hereby made a part of this description.

Section 2. A complete survey of the above-described property by a competent surveyor is attached to this ordinance and by reference is made a part of this ordinance and is of file in the office of the Clerk of the City of Fitzgerald.

Section 3. The City of Fitzgerald Zoning District Map is hereby amended to include the lands described in this ordinance, and said lands shall have the zoning classification of G-B.

Section 4. This annexation ordinance shall become effective for ad valorem tax purposes on December 31 of the year during which such annexation occurred and for all other purposes shall become effective on the first day of the month following the month during which the requirements of Article 2 of O.C.G.A. Chapter 36-36 have been met, including the requirement that an identification of the property so annexed shall be filed with the Department of Community Affairs and with the governing authority of Ben Hill County, Georgia, in accordance with O.C.G.A. § 36-36-3.

Section 5. In the event any provision or portion of this ordinance shall be unconstitutional or invalid, the remaining portion shall remain in full force and effect.

Section 6. Any portion of any ordinance in conflict with this ordinance is hereby repealed.

DATE OF FIRST READING: November 13, 2023

DATE OF SECOND READING: December 11, 2023

PASSED BY THE FOLLOWING VOTE:

"YES"	<u>9</u>
"NO"	<u>0</u>
"ABSTAIN"	<u>0</u>



APPROVED: Jane Stiles
MAYOR

ATTEST: Cristina Lamm
CITY CLERK

JAY, SHERRELL, SMITH, BRADDY & COOK, P.C.

ATTORNEYS AT LAW

CLAYTON JAY (1883-1969)
ALLAN C. GARDEN (1895-1972)
HARVEY L. JAY (1906-1992)
CLAYTON JAY, JR.
ROBERT E. SHERRELL
JOHN E. SMITH, III
M. GILL BRADDY
KYLE C. COOK

P.O. BOX 308
101 E. PINE ST.
FITZGERALD, GA 31750

TELEPHONE (229) 423-2027
FACSIMILE (229) 423-9327

December 13, 2023

CERTIFIED MAIL
RETURN RECEIPT REQUESTED

Chief, Voting Rights Section
Civil Rights Division
Room 7254 – NWB
Department of Justice
950 Pennsylvania Ave., NW
Washington, DC 20530

Re: City of Fitzgerald, Georgia, Application for Approval of Annexation Ordinance No. 23-1613

Dear Sir or Madam:

This submission is being made on behalf of the City of Fitzgerald, Georgia, by the undersigned attorneys who are the city attorneys for Fitzgerald, Georgia.

All annexations of property to the City of Fitzgerald since 1964, prior to the enactment of the enclosed ordinances, have been approved by the U.S. Department of Justice.

The City of Fitzgerald is located in Ben Hill County, Georgia. Ben Hill County is located near the geographic center of the southern half of the State of Georgia. The City of Fitzgerald is the only municipality located within Ben Hill County.

Throughout the time from 1964 to the present, the City of Fitzgerald has pursued a policy of allowing the annexation of any property adjacent to its corporate limits, at the request of the owner thereof. These annexations have consisted in almost every instance of vacant property that was subsequently converted into residential, commercial or industrial use subsequent to its annexation to the city. The city has annexed property, unoccupied at the time of its annexation, and subsequently converted to residential use, on all sides of the city. The city has annexed unoccupied property subsequently converted to commercial use on the south side of the city. The city has annexed unoccupied property subsequently converted to industrial use on the east and south sides of the city.

The African-American populations in Ben Hill County are found, for the most part, in three areas. The first area is within the City of Fitzgerald, and is located partly within the corporate limits as they existed prior to 1964, and partly within areas annexed on the east side of Fitzgerald. Another area of substantial African-American population is found approximately 8 miles north of Fitzgerald.

COVER SHEET

ORDINANCE No. 23-1613

- A. A copy of this ordinance is attached hereto. The lands lie in one parcel.
- B. This Ordinance expands the corporate limits of the City of Fitzgerald. It does not supersede any prior legislative act with respect to the lands covered by this annexation.
- C. This parcel of land is zoned for General Business use (GB). There are no residences located thereon. The annexation of these lands will have no significant effect on voting.
- D. This submission is made by Kyle C. Cook, of Jay, Sherrell, Smith, Braddy & Cook, P.C., Attorneys at law, City Attorneys of the City of Fitzgerald, P.O. Box 308, Fitzgerald, GA 31750, telephone no. (229) 423-2027.
- E. The submitting authority is the Mayor and Council of the City of Fitzgerald. The name of the jurisdiction responsible for the change is the City of Fitzgerald, Georgia.
- F. The City of Fitzgerald, Georgia, is located within Ben Hill County, Georgia.
- G. The mode of decision whereby this annexation was accomplished was by local ordinance enacted by the Mayor and Council of the City of Fitzgerald.
- H. Annexations by the City of Fitzgerald by local ordinance are enacted by the Mayor and Council of the City of Fitzgerald pursuant to Official Code of Georgia Annotated § 36-36-2. Under this provision, lands contiguous to the existing city limits may be annexed by a municipality upon the request of the landowner.
- I. The ordinance was approved on the 11th day of December, 2023.
- J. The ordinance became effective on the 1st day of January, 2024 (under State law).
- K. The change has been enforced or administered.
- L. The change only affected the land involved in the annexation.
- M. The City of Fitzgerald has a policy of granting all requests for annexation of property contiguous to the corporate limits of the City of Fitzgerald. The owners of this property have requested that it be annexed.

Chief, Voting Rights Section
12/13/2023
Page 2

There are no substantial areas occupied by African-Americans, located immediately adjacent to the existing city limits.

Enclosed is a map of the City of Fitzgerald and Ben Hill County. The area affected by these ordinances are marked on the map.

Also enclosed are copies of the entire annexation ordinances. These have been given final approval by the Mayor and Council of the City of Fitzgerald. Attached to each ordinance is a cover sheet that gives you the information necessary to review these ordinances under the Voting Rights Act.

There has never been any actual or threatened litigation regarding the annexation of property to the City of Fitzgerald and its effect on voting practices or voting rights.

The annexation of these properties will not alter or diminish the voting strength of minorities within the City of Fitzgerald, to any appreciable extent.

The City Council consists of nine members, at the time of passage, four of whom are white and five of whom are African-American. The names and telephone numbers of the five African-American aldermen are as follows:

Dennis Jefferson	229-424-0123
Albert Webb	229-423-5405
Earl Brown	
Kevin Johnson	229-457-2549
Sheila Jefferson	

If you require further information, please let me know.

Best Regards,



Kyle W. Cook

Enc
Cc w/ enc Ben Hill County Commission
Kathy Young, City of Fitzgerald

City of Fitzgerald

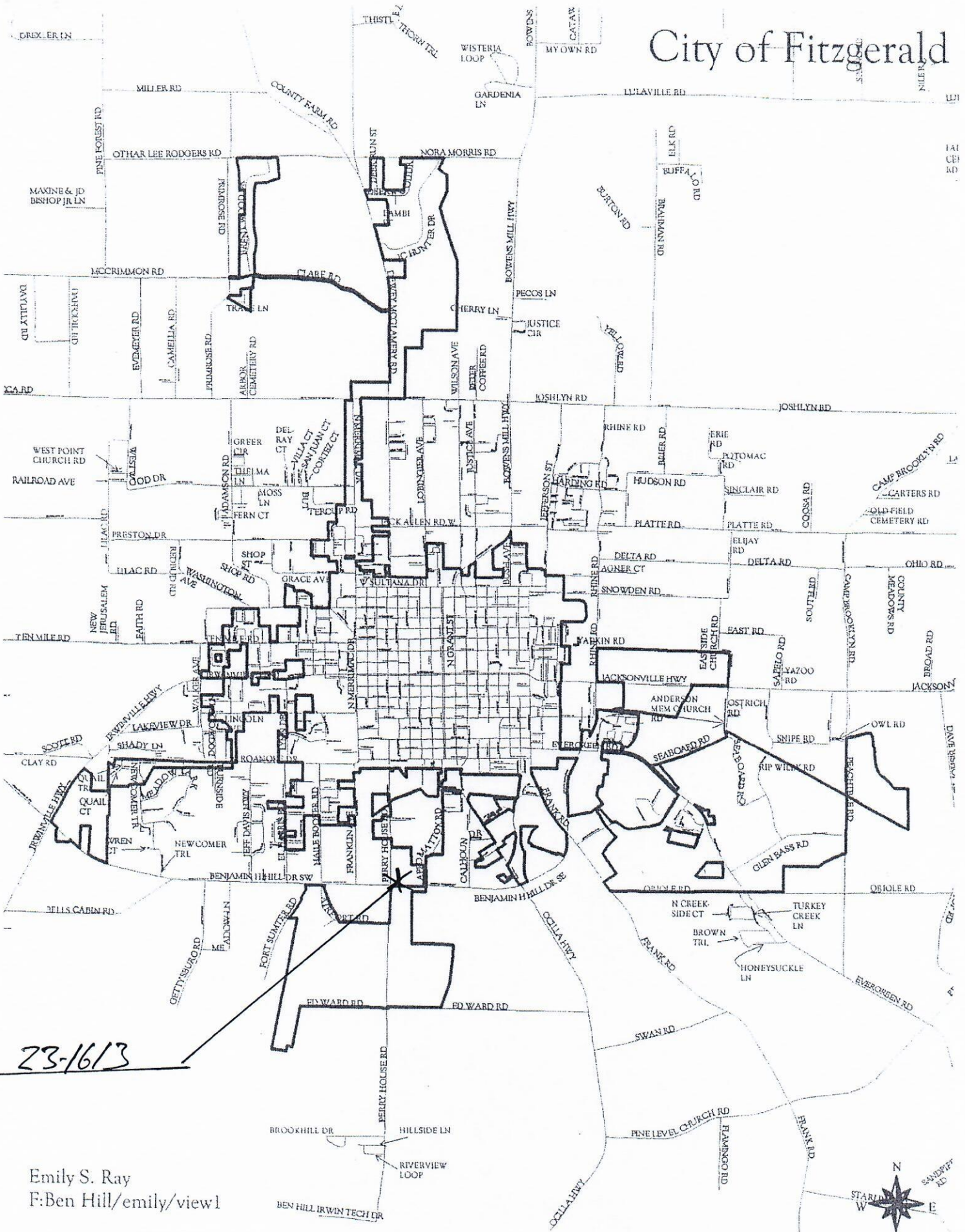

23-1613

Emily S. Ray
F: Ben Hill/emily/view1

